

The Best Venue for you

Suwon Convention Center

Suwon
Convention
Center

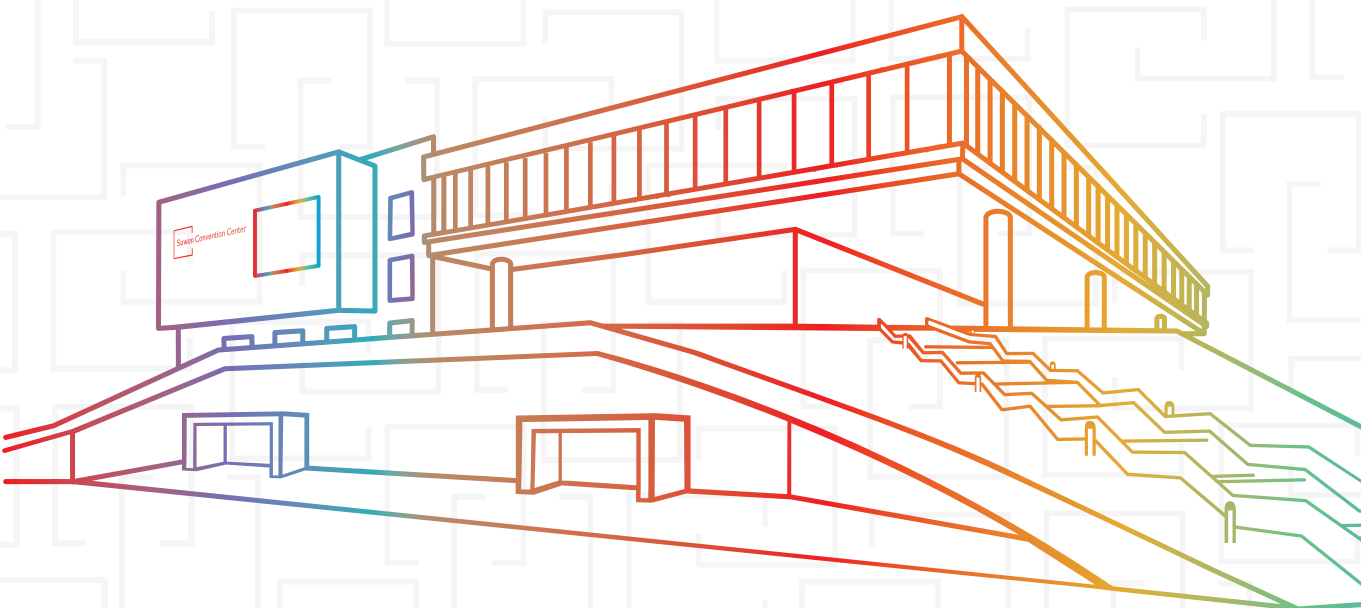

The Best Venue for you, Suwon Convention Center

수원컨벤션센터 건립개요

- 위치 : 광교택지개발사업지구 내
- 대지면적 : 50,005㎡ (지하2층, 지상5층 규모/연면적 97,602㎡)
- 센터구성
 - 전시홀 : 7,877㎡ (2분할 또는 3분할 가능, 500부스, 높이 12m, 하중 3ton/㎡)
 - 컨벤션홀 : 3,040㎡ (3분할 가능, 3,000명, 높이 13m, 하중 1.5ton/㎡)
 - 이벤트홀 : 308㎡
 - 회의실 : 28개 회의실 (통합가능)
 - 주차규모 : 1,099대

Overview of Suwon Convention Center

- Location : Within the land development project area of the Gwanggyo district
- Site area : 50,005㎡ [2 floors below ground and 5 floors above ground / Total building area 97,602㎡]
- Center Facilities
 - Exhibition hall : 7,877㎡ (divisible into 2 halls or 3 halls)
 - Convention hall : 3,040㎡ (divisible into 3 halls)
 - Event hall : 308㎡
 - Meeting rooms : A total of 28 Meeting rooms
 - Parking capacity : 1,099 vehicles

220년 전 정조가 설계했던 조선 최고의 계획도시, 水原. 바로 여기 당신을 위한 VENUE가 있습니다.
찬란한 역사와 전통 위에 첨단과 자연이 어우러진 수원의 랜드마크, 수원컨벤션센터를 만나면 당신의 History가 달라집니다.

Suwon, known as the best planned city of the Joseon Dynasty, was designed by the King Jeongjo with hopes to make it the City of Dream more than two centuries ago. It has been preparing to provide you with a best MICE venue, Suwon Convention Center. As the Suwon's landmark, harmonizing the state-of-the-art technologies and the nature on the basis of a splendid history and tradition, it is expected to open a new chapter in your MICE history.



1796

1995

1997

2016

2019

2020

수원화성 읍성 (경조18년)
Suwon Hwaseong Fortress and
Town Castle (18th year of King Jeongjo)

수원컨벤션센터 건립 구상
Planning for the Establishment of
Suwon Convention Center

「수원화성」 유네스코 세계문화유산 등재
Suwon Hwaseong Fortress registered as
a UNESCO World Heritage Site

수원컨벤션센터 착공
Construction of
Suwon Convention Center

수원컨벤션센터 개관
Opening of
Suwon Convention Center

수원MICE 복합단지 완공
(호텔, 백화점, 이쿠아리움)
Opening of Suwon MICE Complex
(Hotel, Department store, Aquarium)

층별안내

Floor Information

Suwon Convention Center

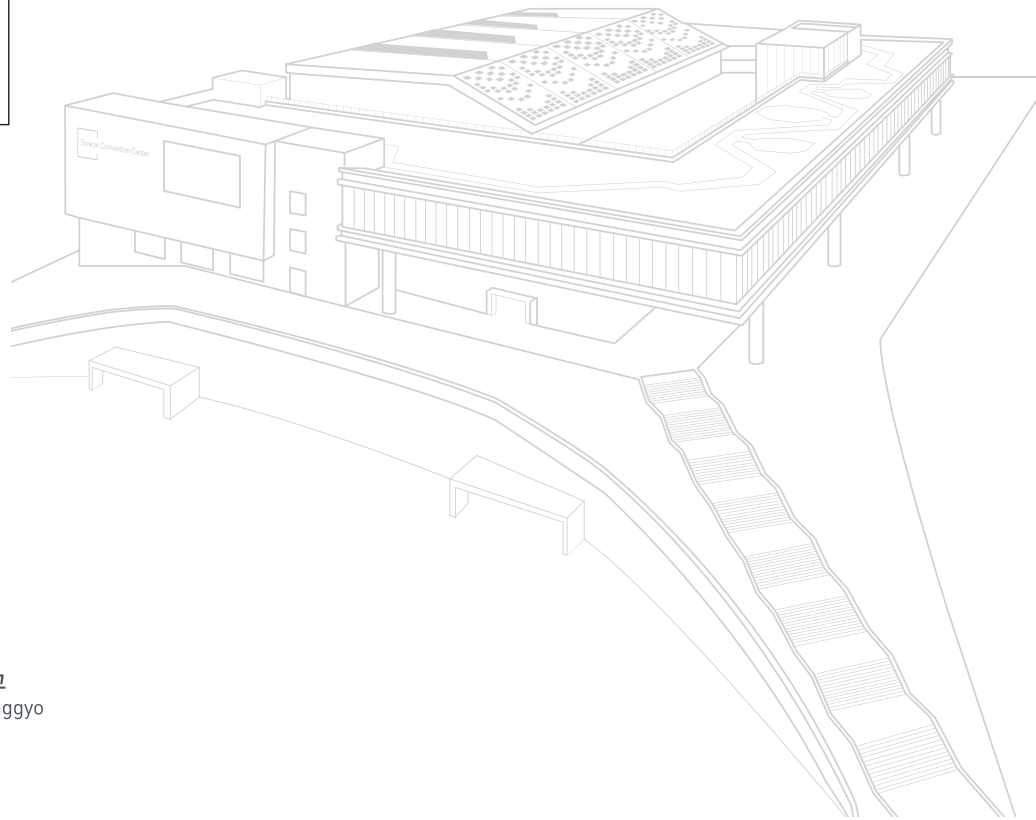
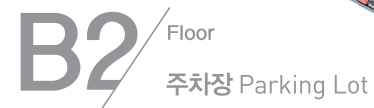
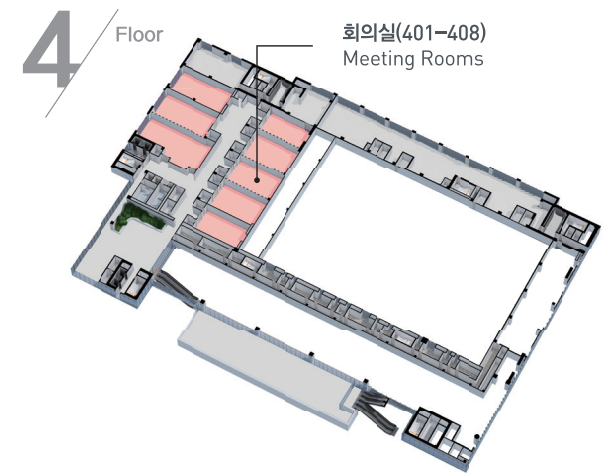
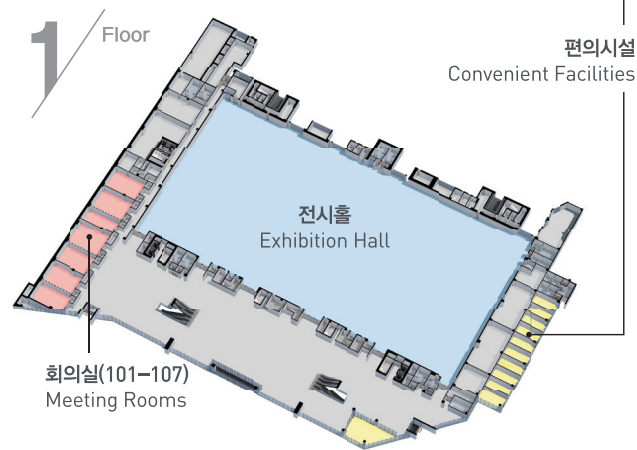
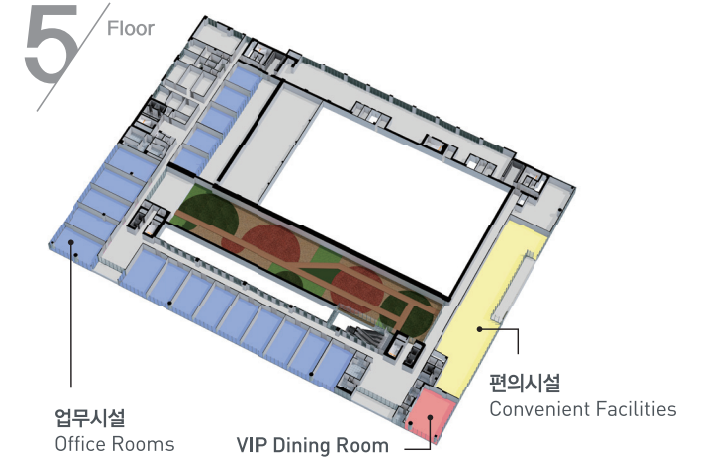
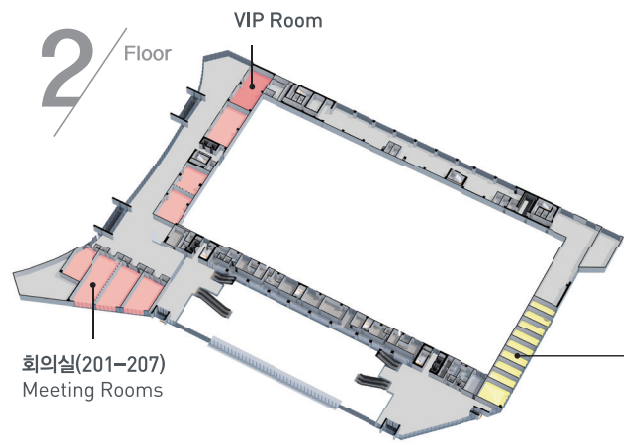

1F 전시홀 | 회의실 (101-107)

Exhibition Hall | Meeting Rooms

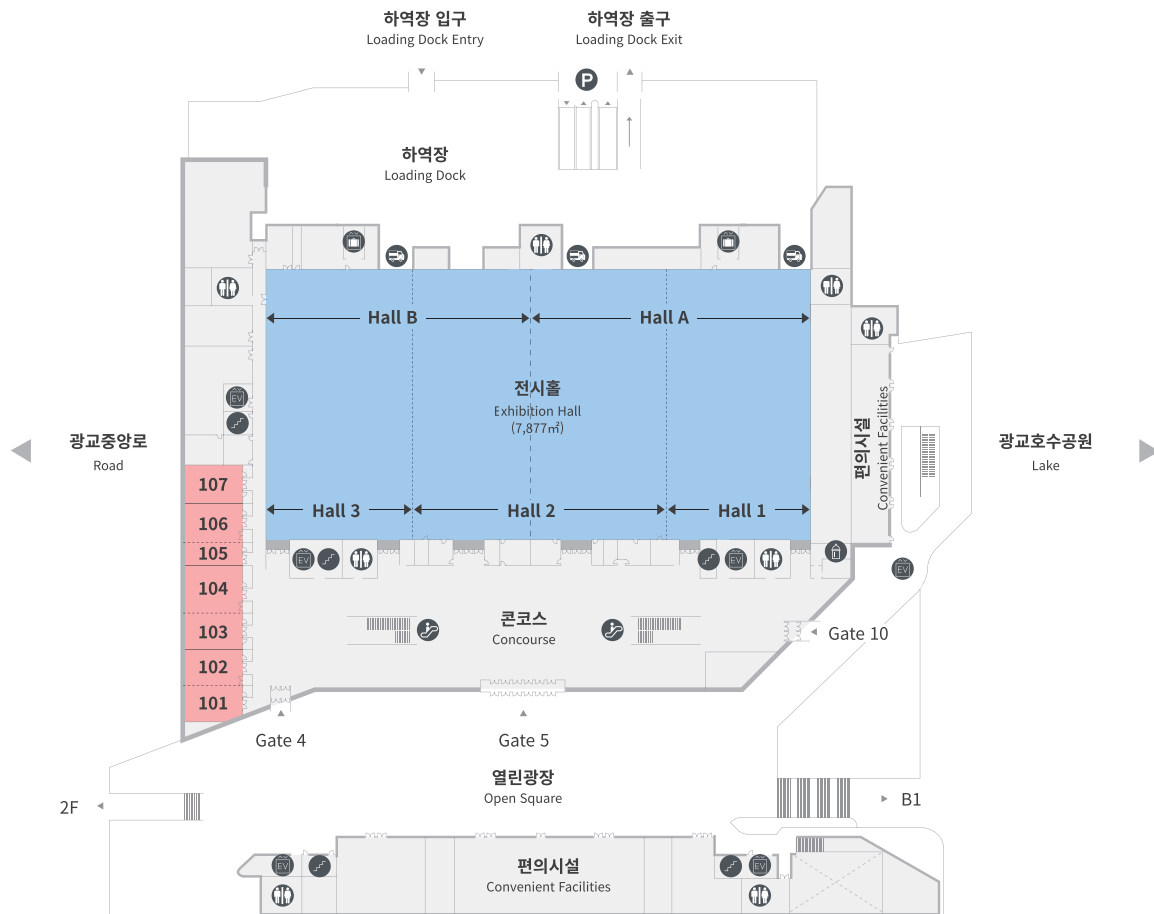

- 엘리베이터 | Elevator
- 화장실 | Restroom
- 수유실 | Nursing Room
- 에스컬레이터 | Escalator
- 화물 엘리베이터 | Freight Elevator
- 계단 | Staircase
- 주차장 | Parking Lot
- 화물출입구 | Cargo Access

장소 Location	분할 Divisibility	규격 Size		면적 Area (㎡)	하중 Floor Load (t/㎡)
		W x L x H (m)			
전시홀 Exhibition Hall	전체 Entire Hall	124.5 x 62 x 12		7,877	3
	2분할 Divisible into 2 Halls	Hall A	66.0 x 62 x 12	4,177	3
		Hall B	58.5 x 62 x 12	3,700	
	3분할 Divisible into 3 Halls	Hall 1	32.8 x 62 x 12	2,095	3
		Hall 2	58.2 x 62 x 12	3,657	
Hall 3		33.5 x 62 x 12	2,125		

장소 Location	규격 Size W x L x H (m)	면적 Area (㎡)	수용인원(명) Capacity(Persons)			
			강의식 Class	극장식 Theater	연회식 Banquet	
회의실 Meeting Rooms	101	13.3 x 8.2 x 2.8	109	63	90	48
	102	13.6 x 8.4 x 2.8	114	63	99	48
	103	13.6 x 8.4 x 2.8	114	63	99	48
	104	13.6 x 10.2 x 2.8	138	84	126	72
	105	13.6 x 6.0 x 2.8	82	42	72	24
	106	13.6 x 9.0 x 2.8	122	84	108	48
	107	13.6 x 8.6 x 2.8	116	63	99	48
	101+102	13.6 x 16.6 x 2.8	223	135	208	96
	103+104	13.6 x 18.6 x 2.8	252	150	224	96
	105+106	13.6 x 15.0 x 2.8	204	120	176	72

2F 회의실 (201-207)

Meeting Rooms

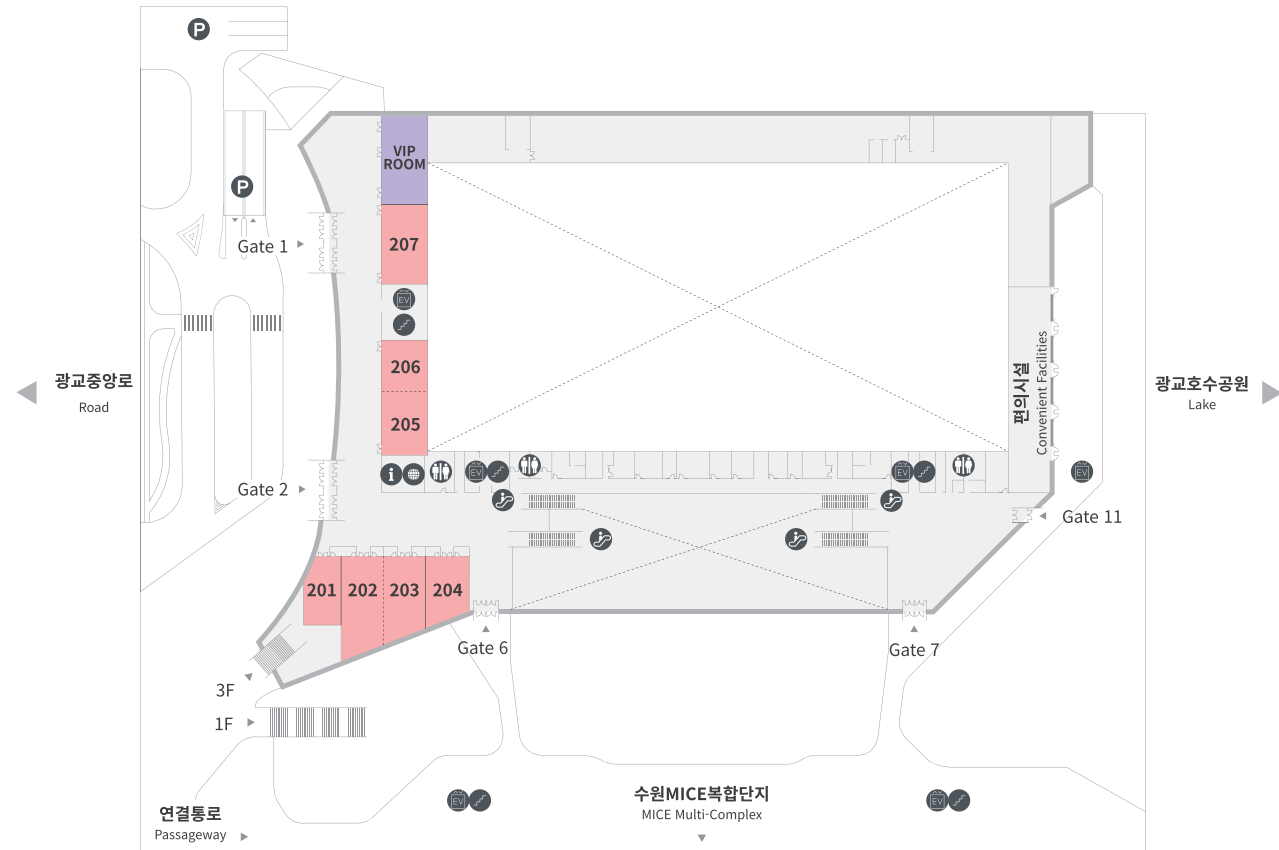

- 엘리베이터 | Elevator
- 화장실 | Restroom
- 안내데스크 | Information Desk
- 에스컬레이터 | Escalator
- 화물 엘리베이터 | Freight Elevator
- 계단 | Staircase
- 주차장 | Parking Lot

장소 Location	규격 Size W x L x H (m)	면적 Area (㎡)	수용인원(명) Capacity(Persons)			
			강의식 Class	극장식 Theater	연회식 Banquet	
회의실 Meeting Rooms	201	8.0 x 14.5 x 2.8	116	(고정식) 종역회의실 21석 (Fixed) U-shape 21 seats		
	202	9.0 x 21.5 x 2.8	193	141	190	80
	203	9.0 x 18.0 x 2.8	162	114	150	64
	204	9.0 x 14.5 x 2.8	130	78	114	48
	205	9.8 x 13.8 x 2.8	135	72	100	48
	206	10.0 x 11.0 x 2.8	110	54	80	32
	207	10.0 x 17.0 x 2.8	170	99	143	64
	202+203	18.0 x 19.7 x 2.8	355	198	270	128
	205+206	10.0 x 24.8 x 2.8	245	144	200	96



전경 | Front View

회의실 | Meeting Rooms

VIP룸(2층) | VIP Room

3F

컨벤션홀 | 회의실 (301-306) Convention Hall | Meeting Rooms

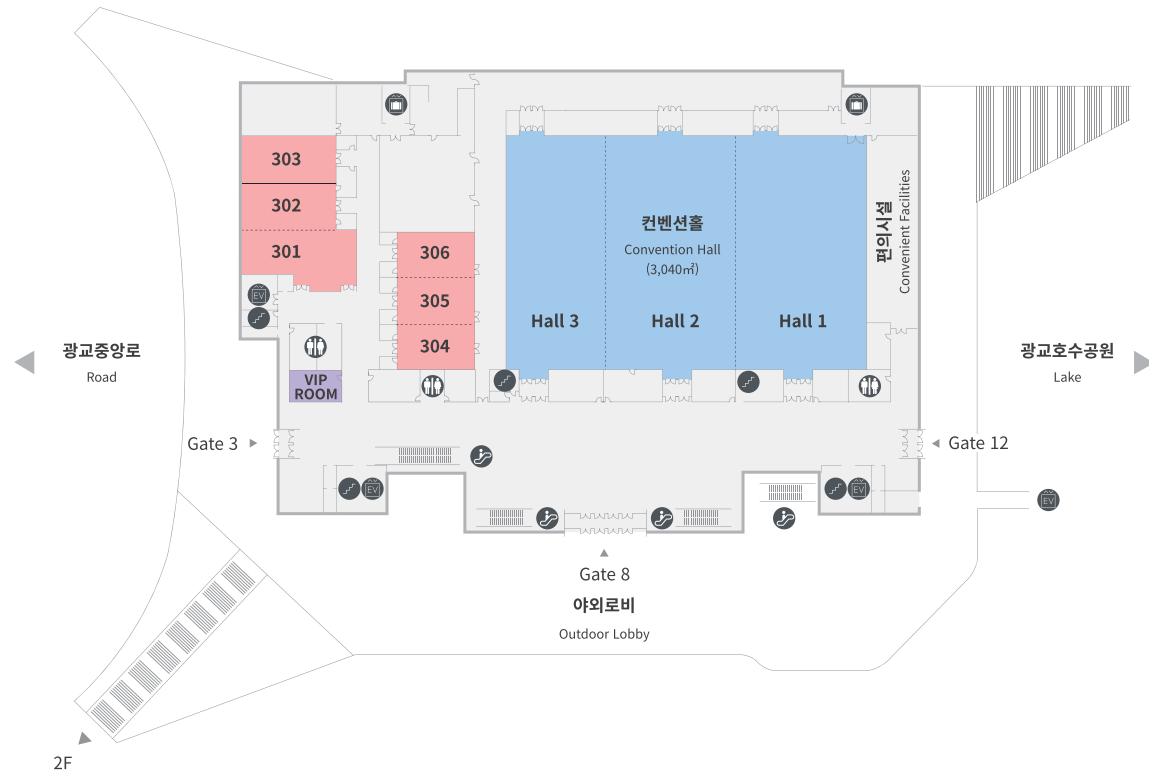

- 엘리베이터 | Elevator
- 화장실 | Restroom
- 계단 | Staircase
- 에스컬레이터 | Escalator
- 화물 엘리베이터 | Freight Elevator

4F

회의실 (401-408) Meeting Rooms

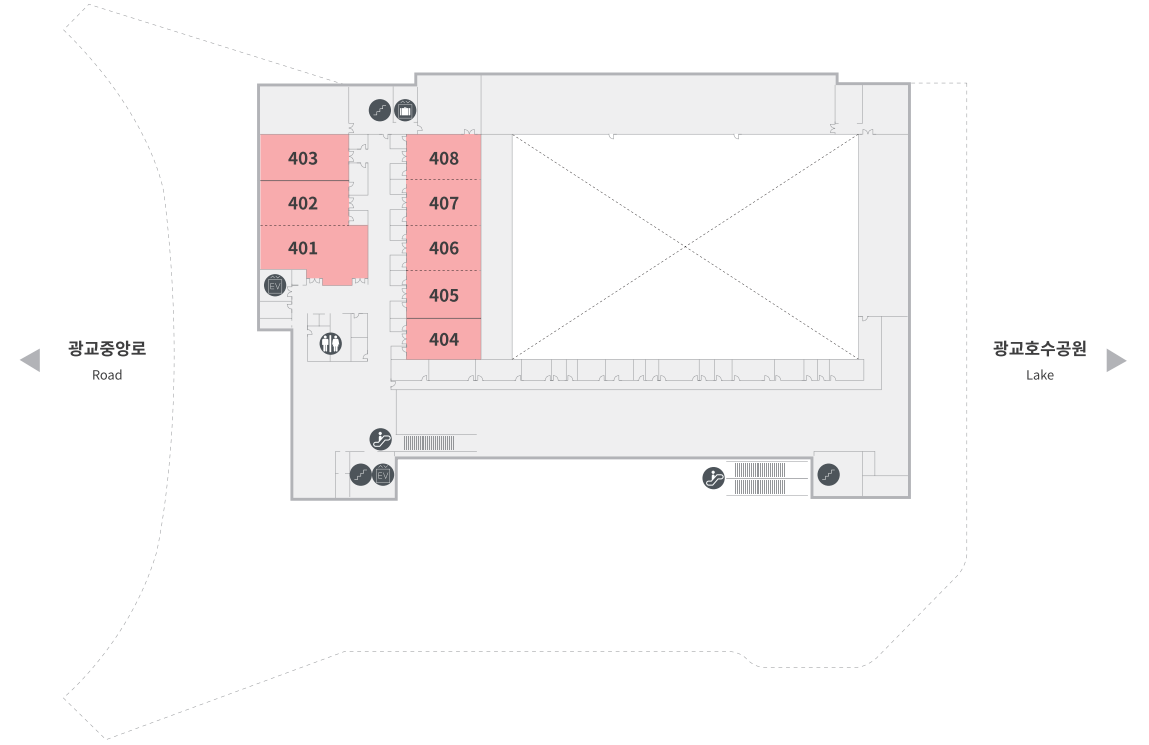

- 엘리베이터 | Elevator
- 화장실 | Restroom
- 계단 | Staircase
- 에스컬레이터 | Escalator
- 화물 엘리베이터 | Freight Elevator

장소 Location	규격 Size W x L x H (m)	면적 Area (㎡)	수용인원(명) Capacity(Persons)			
			강의식 Class	극장식 Theater	연회식 Banquet	
컨벤션홀 Convention Hall	전체 Entire Hall	68.0 × 44.7 × 13.0	3,040	1,800	2,916	1,264
	1홀 Hall 1	24.8 × 44.7 × 13.0	1,108	648	1,088	480
	2홀 Hall 2	24.6 × 44.7 × 13.0	1,100	648	1,088	480
	3홀 Hall 3	18.6 × 44.7 × 13.0	832	576	832	400
	1+2홀 Hall 1+2	49.4 × 44.7 × 13.0	2,208	1,260	2,052	880
	2+3홀 Hall 2+3	43.2 × 44.7 × 13.0	1,932	1,224	1,920	880
회의실 Meeting Rooms	301	21.5 × 10.0 × 2.8	215	144	192	80
	302	18.0 × 8.7 × 2.8	156	120	168	64
	303	18.0 × 9.0 × 2.8	162	117	168	64
	304	14.5 × 9.0 × 2.8	130	96	120	48
	305	14.5 × 9.0 × 2.8	130	96	120	48
	306	14.5 × 8.7 × 2.8	126	96	120	48
	301+302	21.5 × 18.7 × 2.8	371	210	336	144
	304+305	14.5 × 18.0 × 2.8	260	180	252	96
	304+305+306	14.5 × 26.7 × 2.8	386	270	378	144

* 컨벤션홀 바닥 하중 : 1.5t/㎡ | Convention Hall Floor Load : 1.5t/㎡

장소 Location	규격 Size W x L x H (m)	면적 Area (㎡)	수용인원(명) Capacity(Persons)			
			강의식 Class	극장식 Theater	연회식 Banquet	
회의실 Meeting Rooms	401	21.5 × 10.0 × 2.8	215	144	192	80
	402	18.0 × 8.7 × 2.8	156	120	168	64
	403	18.0 × 9.0 × 2.8	162	117	168	64
	404	14.5 × 8.7 × 2.8	126	96	120	48
	405	14.5 × 9.0 × 2.8	130	96	120	48
	406	14.5 × 9.0 × 2.8	130	96	120	48
	407	14.5 × 9.0 × 2.8	130	96	120	48
	408	14.5 × 8.7 × 2.8	126	96	120	48
	401+402	21.5 × 18.7 × 2.8	371	210	336	144
	405+406	14.5 × 18.0 × 2.8	260	180	252	96
	407+408	14.5 × 17.7 × 2.8	256	180	252	96
	405+406+407	14.5 × 27.0 × 2.8	390	270	378	144
	406+407+408	14.5 × 26.7 × 2.8	386	270	378	144
	405+406+407+408	14.5 × 35.7 × 2.8	516	360	486	216

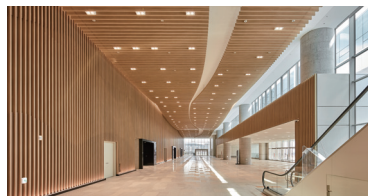

로비 | Lobby

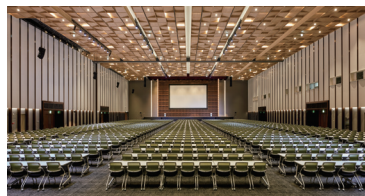

컨벤션홀 | Convention Hall



VIP룸(3층) | VIP Room

기타 시설

Other Facilities

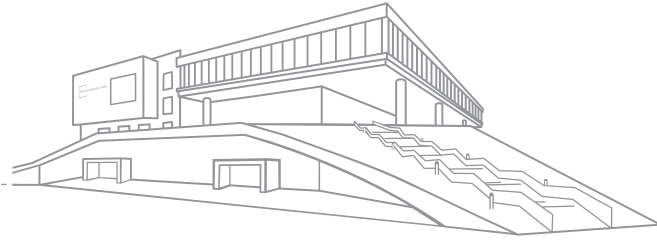

B1 이벤트홀

Event Hall

면적 | Area 308㎡



전동 수납식 좌석 (256석) | Motorized retractable seats

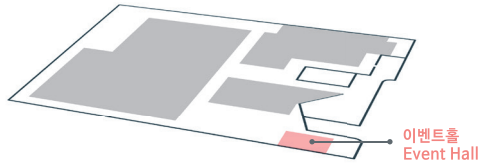

이벤트홀
Event Hall

이벤트홀은 수원 시민들에게 무료로 제공되는 열린 공간입니다.

The event hall, an open space, is available for Suwon citizens for free.

교통

Transportation

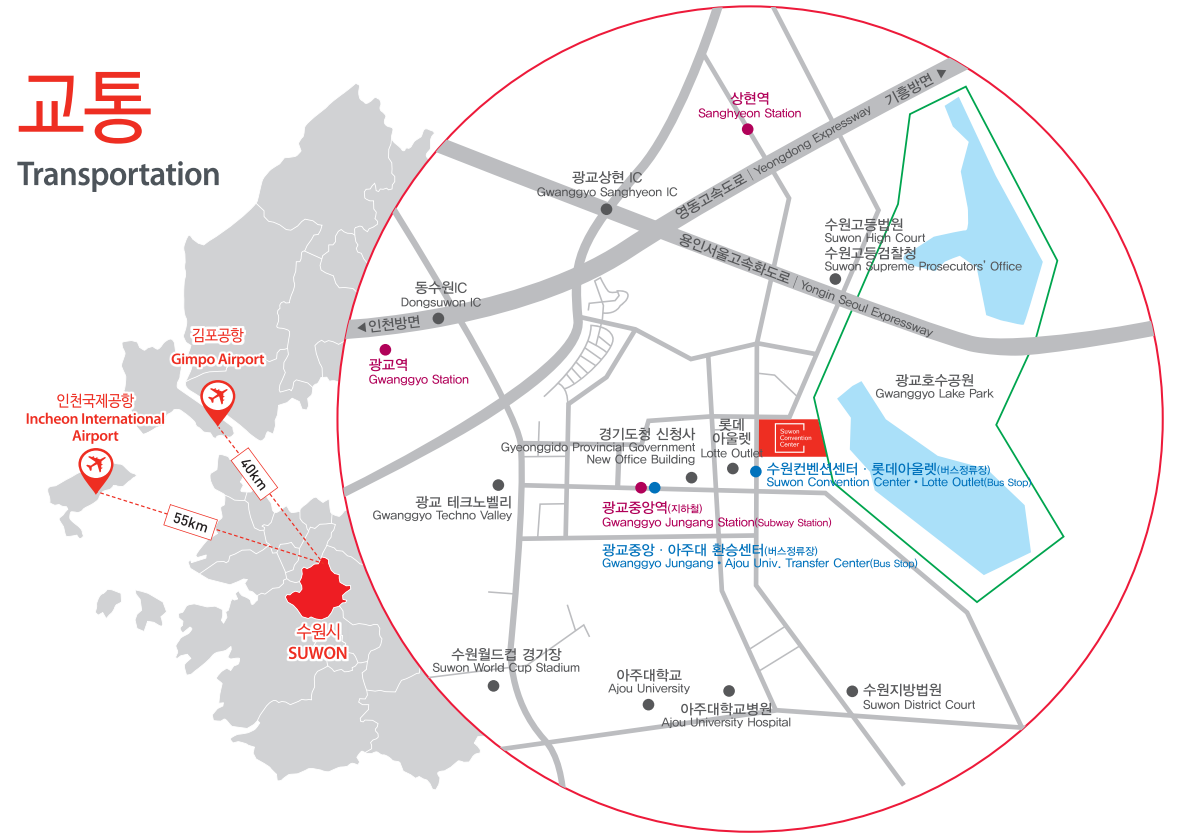

5F VIP 다이닝룸

VIP Dining Room

면적 | Area 217㎡



전시홀, 컨벤션홀, 회의실 대관시 호수전망의 고품격 VIP 다이닝룸을 무료로 이용하실 수 있습니다.

※ 식사시 사용 가능

High-level VIP Dining room with a beautiful lake view is provided free of charge when leasing an exhibition hall, a convention hall or meeting rooms.

※ Catering purpose only

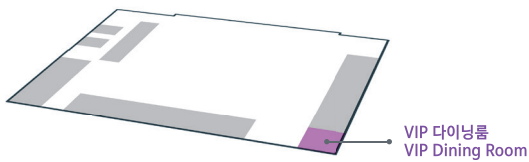

VIP 다이닝룸
VIP Dining Room

RF 구름정원

Cloud Garden

면적 | Area 5,584㎡

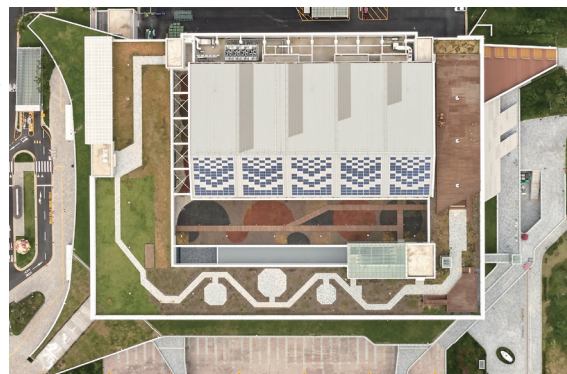

구름정원은 광교호수공원의 아름다운 풍경과 함께 리셉션 등 특별한 행사가 가능한 공간입니다.

The Cloud Garden, boasting the beautiful view of the Gwanggyo Lake Park, is the best place for special events such as reception.

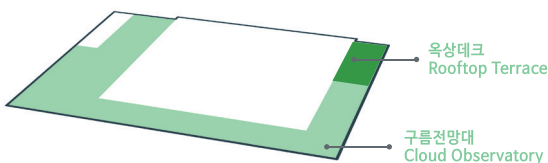

옥상데크
Rooftop Terrace

구름전망대
Cloud Observatory

수원MICE복합단지

Suwon MICE-Multi Complex

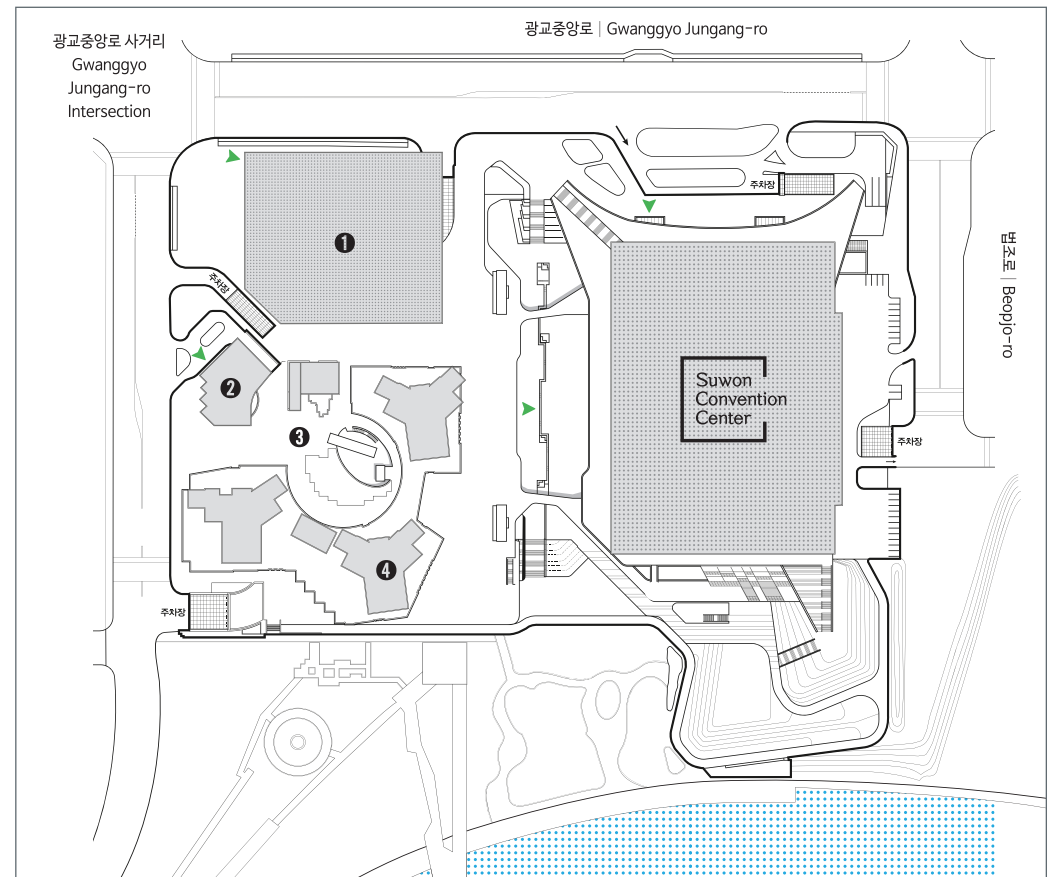

- 1 갤러리아 광교(백화점)
Galleria Gwanggyo
- 2 코트야드 메리어트 수원(호텔)
Courtyard by Marriott Suwon
- 3 한화아쿠아플라넷 광교(아쿠아리움)
Hanwha Aqua Planet Gwanggyo
- 4 포레나 광교(오피스텔)
Business Facilities

The logo for the Suwon Convention Center features the text "Suwon Convention Center" in a bold, red, sans-serif font. The text is enclosed within a red square frame that has a unique, stylized shape with notched corners.

Suwon Convention Center

수원컨벤션센터

16514 경기도 수원시 영통구 광고중앙로 140(하동)

16514, 140, Gwanggyojungang-ro, Yeongtong-gu, Suwon-si, Gyeonggi-do, Republic of Korea

Website. www.scc.or.kr