

The Best Venue for you

# Suwon Convention Center

Suwon  
Convention  
Center

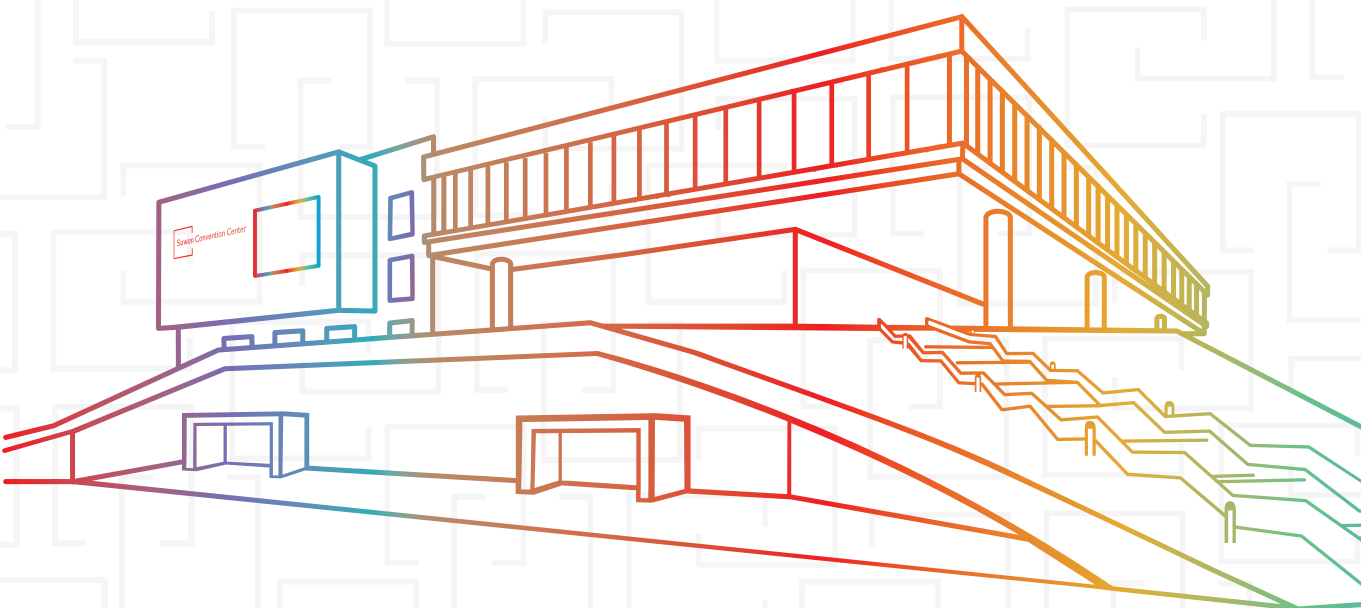

# The Best Venue for you, Suwon Convention Center

## 수원컨벤션센터 건립개요

- 위치 : 광고택지개발사업지구 내
- 공사기간 : 2016. 08 ~ 2019. 03
- 대지면적 : 50,005㎡ (지하2층, 지상5층 규모/연면적 97,602㎡)
- 센터구성
  - 전시 홀 : 7,877㎡ (2분할 또는 3분할 가능, 500부스, 높이 12m, 하중 3ton/㎡)
  - 컨벤션홀 : 3,040㎡ (3분할 가능, 3,000명, 높이 13m, 하중 1.5ton/㎡)
  - 이벤트홀 : 308㎡
  - 회의실 : 28개 회의실 (통합가능)
  - 주차규모 : 1,099대

## Overview of Suwon Convention Center

- Location : Within the land development project area of the Gwanggyo district
- Construction period : August 2016 ~ March 2019
- Site area : 50,005㎡ (2 floors below ground and 5 floors above ground / Total building area 97,602㎡)
- Center Facilities
  - Exhibition hall : 7,877㎡ (divisible into 2 halls or 3 halls)
  - Convention hall : 3,040㎡ (divisible into 3 halls)
  - Event hall : 308㎡
  - Meeting rooms : A total of 28 Meeting rooms
  - Parking capacity : 1,099 vehicles



1796

1995

1997

수원화성 읍성(경조(18년))  
Suwon Hwaseong Fortress and  
Town Castle (18th year of King Jeongjo)

수원컨벤션센터 건립 구상  
Planning for the Establishment of  
Suwon Convention Center

「수원화성」 유네스코 세계문화유산 등재  
Suwon Hwaseong Fortress registered as  
a UNESCO World Heritage Site

220년 전 정조가 설계했던 조선 최고의 계획도시, 水原. 바로 여기 당신을 위한 VENUE가 있습니다.

찬란한 역사와 전통 위에 첨단과 자연이 어우러진 수원의 랜드마크, 수원컨벤션센터를 만나면 당신의 History가 달라집니다.

Suwon, known as the best planned city of the Joseon Dynasty, was designed by the King Jeongjo with hopes to make it the City of Dream more than two centuries ago. It has been preparing to provide you with a best MICE venue, Suwon Convention Center. As the Suwon's landmark, harmonizing the state-of-the-art technologies and the nature on the basis of a splendid history and tradition, it is expected to open a new chapter in your MICE history.

2014

컨벤션센터 건립사업 정상화 협약 체결  
Signing of the agreement for  
the normalization of  
Suwon Convention Center construction

2016

수원컨벤션센터 착공  
Construction of  
Suwon Convention Center

2019

수원컨벤션센터 개관  
Opening of  
Suwon Convention Center

# 층별안내

## Floor Information

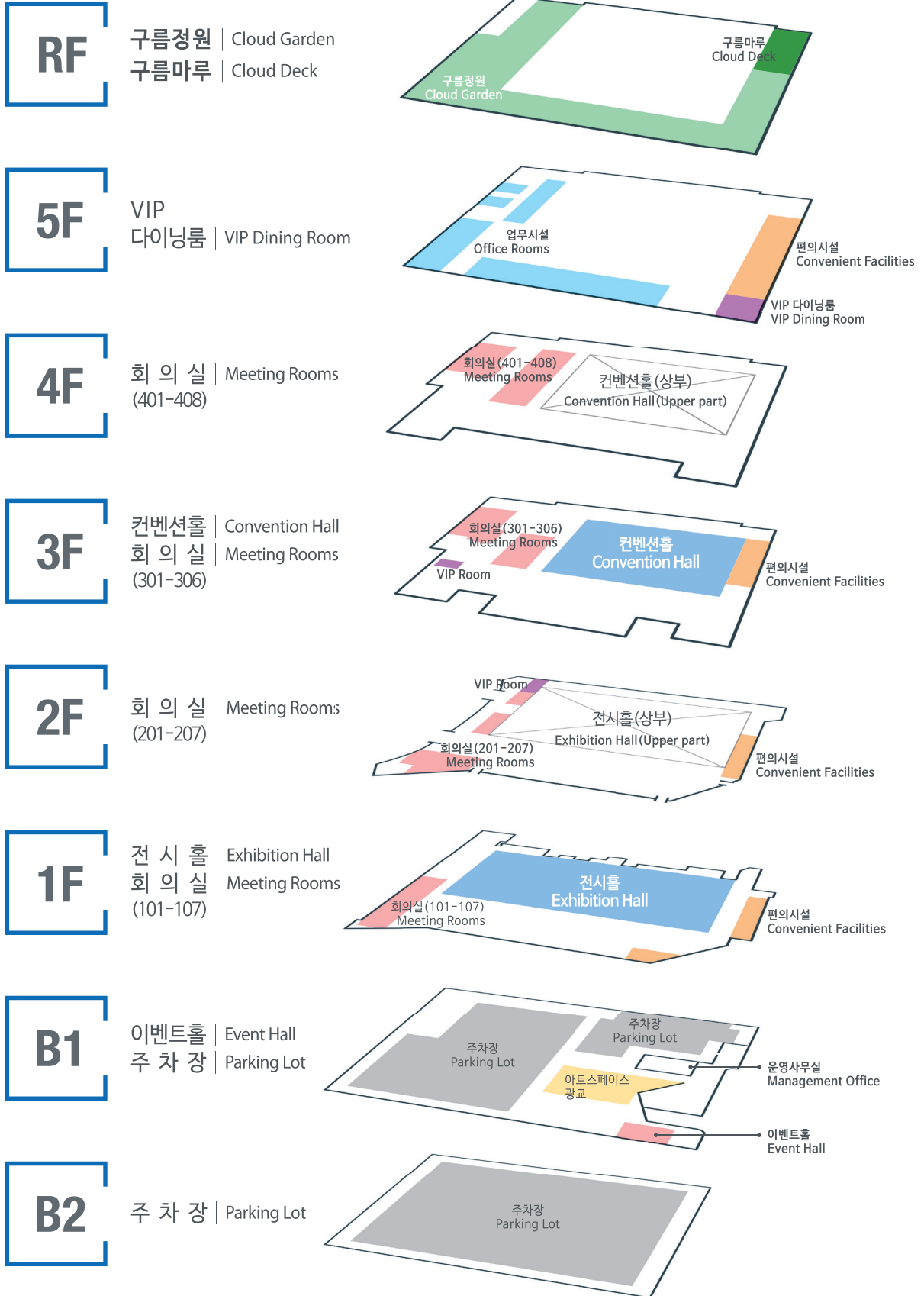

1F

# 전시홀 | 회의실 (101-107)

Exhibition Hall | Meeting Rooms

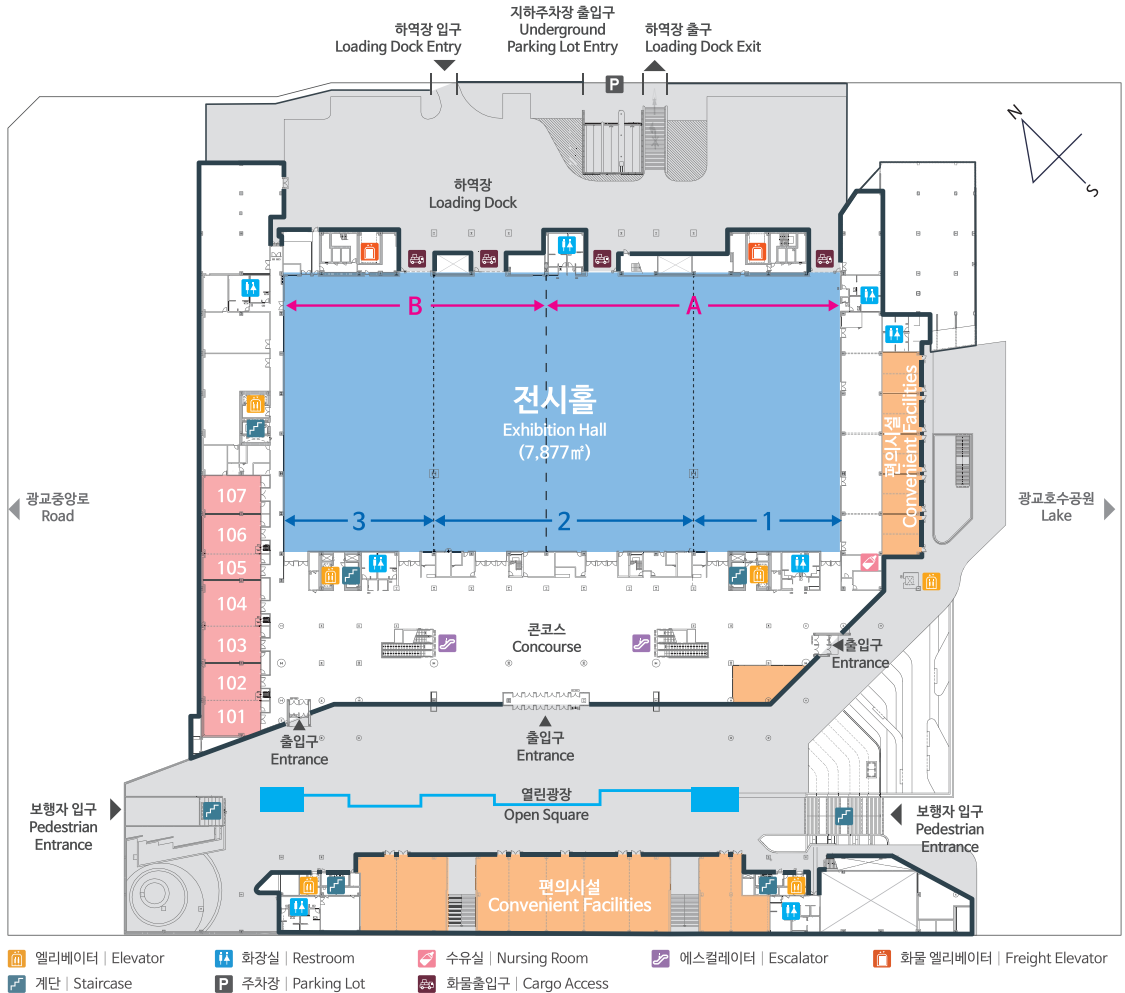

장소 Location	분할 Divisibility	규격   Size	면적   Area	하중   Floor Load	
		W x L x H (m)	(m <sup>2</sup> )	(t/m <sup>2</sup> )	
전시홀 Exhibition Hall	전체   Entire Hall	126.0 × 62.5 × 12.0	7,877	3	
	2분할 Divisible into 2 Halls	Hall A	66.5 × 62.5 × 12.0	4,177	3
		Hall B	59.5 × 62.5 × 12.0	3,700	
	3분할 Divisible into 3 Halls	Hall 1	33.5 × 62.5 × 12.0	2,095	3
		Hall 2	58.5 × 62.5 × 12.0	3,657	
Hall 3		34.0 × 62.5 × 12.0	2,125		

장소 Location		규격   Size	면적   Area	수용인원(명)   Capacity(Persons)		
		W x L x H (m)	(m <sup>2</sup> )	강의식   Class	극장식   Theater	연회식   Banquet
회의실 Meeting Rooms	101	13.3 × 8.2 × 2.8	109	63	90	48
	102	13.6 × 8.4 × 2.8	114	63	99	48
	103	13.6 × 8.4 × 2.8	114	63	99	48
	104	13.6 × 10.2 × 2.8	138	84	126	72
	105	13.6 × 6.0 × 2.8	82	42	72	24
	106	13.6 × 9.0 × 2.8	122	84	108	48
	107	13.6 × 8.6 × 2.8	116	63	99	48
	101+102	13.6 × 16.6 × 2.8	223	135	208	96
	103+104	13.6 × 18.6 × 2.8	252	150	224	96
105+106	13.6 × 15.0 × 2.8	204	120	176	72	

2F

# 회의실 (201-207)

Meeting Rooms

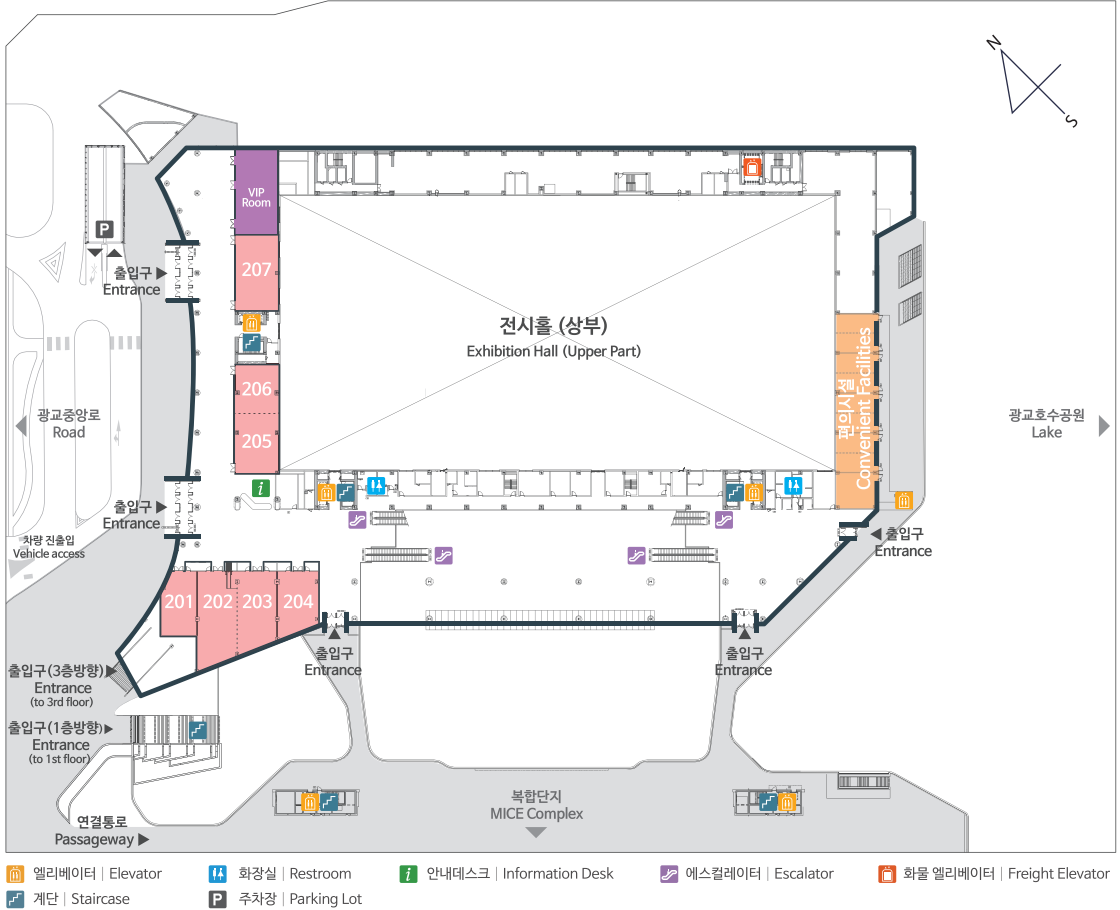

장소 Location	규격   Size W x L x H (m)	면적   Area (㎡)	수용인원 (명)   Capacity (Persons)			
			강의식   Class	극장식   Theater	연회식   Banquet	
회의실 Meeting Rooms	201	8.0 × 14.5 × 2.8	(고정식) 중역회의실 21석   (Fixed) U-shape 21 seats			
	202	9.0 × 21.5 × 2.8	141	190	80	
	203	9.0 × 18.0 × 2.8	114	150	64	
	204	9.0 × 14.5 × 2.8	78	114	48	
	205	9.8 × 13.8 × 2.8	72	100	48	
	206	10.0 × 11.0 × 2.8	54	80	32	
	207	10.0 × 17.0 × 2.8	99	143	64	
	202+203	18.0 × 19.7 × 2.8	355	198	270	128
	205+206	10.0 × 24.8 × 2.8	245	144	200	96



전경 | Front View



회의실 | Meeting Rooms



VIP룸(2층) | VIP Room

3F

# 컨벤션홀 | 회의실 (301-306)

Convention Hall | Meeting Rooms

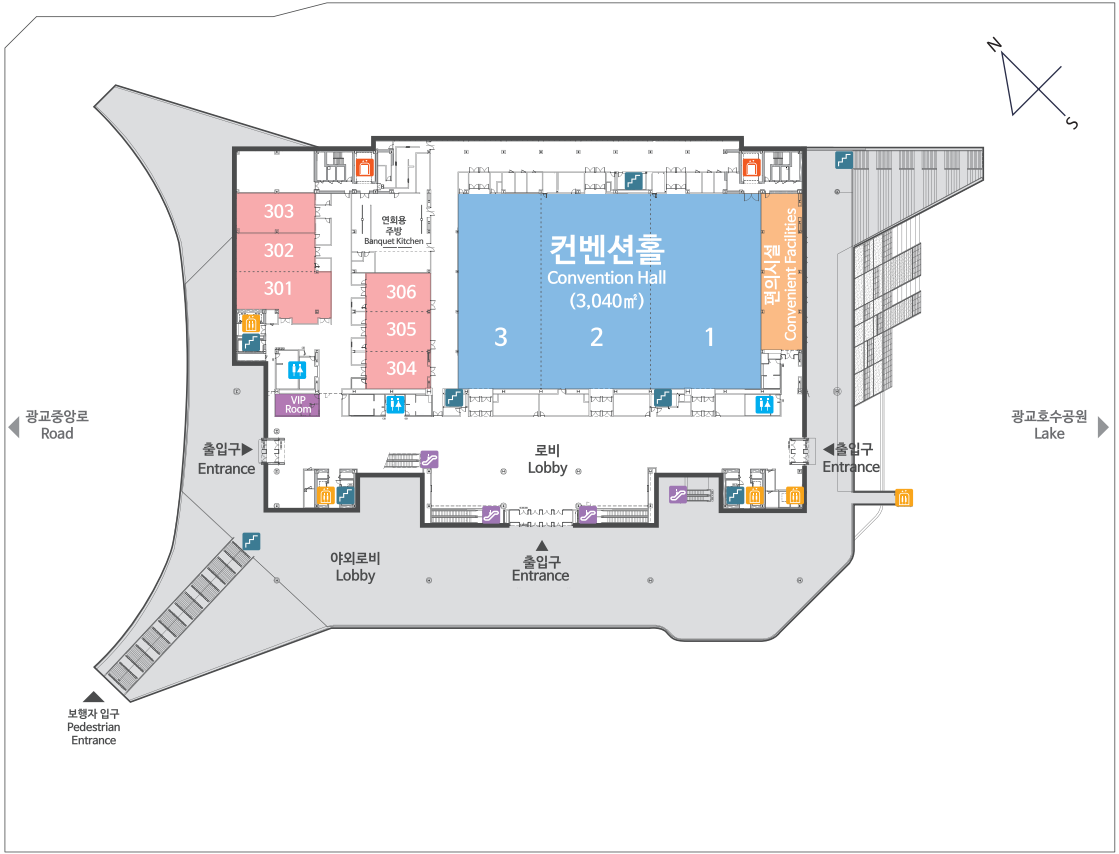

엘리베이터 | Elevator    화장실 | Restroom    계단 | Staircase    에스컬레이터 | Escalator    화물 엘리베이터 | Freight Elevator

장소 Location	규격   Size W x L x H (m)	면적   Area (㎡)	수용인원(명)   Capacity(Persons)			
			강의식   Class	극장식   Theater	연회식   Banquet	
컨벤션홀 Convention Hall	전체   Entire Hall	68.0 × 44.7 × 13.0	3,040	1,800	2,916	1,264
	1홀   Hall 1	24.8 × 44.7 × 13.0	1,108	648	1,088	480
	2홀   Hall 2	24.6 × 44.7 × 13.0	1,100	648	1,088	480
	3홀   Hall 3	18.6 × 44.7 × 13.0	832	576	832	400
	1+2홀   Hall 1+2	49.4 × 44.7 × 13.0	2,208	1,260	2,052	880
	2+3홀   Hall 2+3	43.2 × 44.7 × 13.0	1,932	1,224	1,920	880
회의실 Meeting Rooms	301	21.5 × 10.0 × 2.8	215	144	192	80
	302	18.0 × 8.7 × 2.8	156	120	168	64
	303	18.0 × 9.0 × 2.8	162	117	168	64
	304	14.5 × 9.0 × 2.8	130	96	120	48
	305	14.5 × 9.0 × 2.8	130	96	120	48
	306	14.5 × 8.7 × 2.8	126	96	120	48
	301+302	21.5 × 18.7 × 2.8	371	210	336	144
	304+305	14.5 × 18.0 × 2.8	260	180	252	96
304+305+306	14.5 × 26.7 × 2.8	386	270	378	144	

\* 컨벤션홀 바닥 하중 : 1.5t/㎡ | Convention Hall Floor Load : 1.5t/㎡

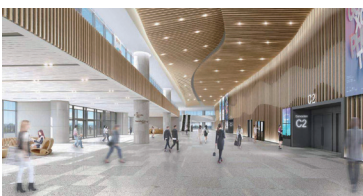

로비 | Lobby



컨벤션홀 | Convention Hall



VIP룸 (3층) | VIP Room

4F

# 회의실 (401-408)

Meeting Rooms

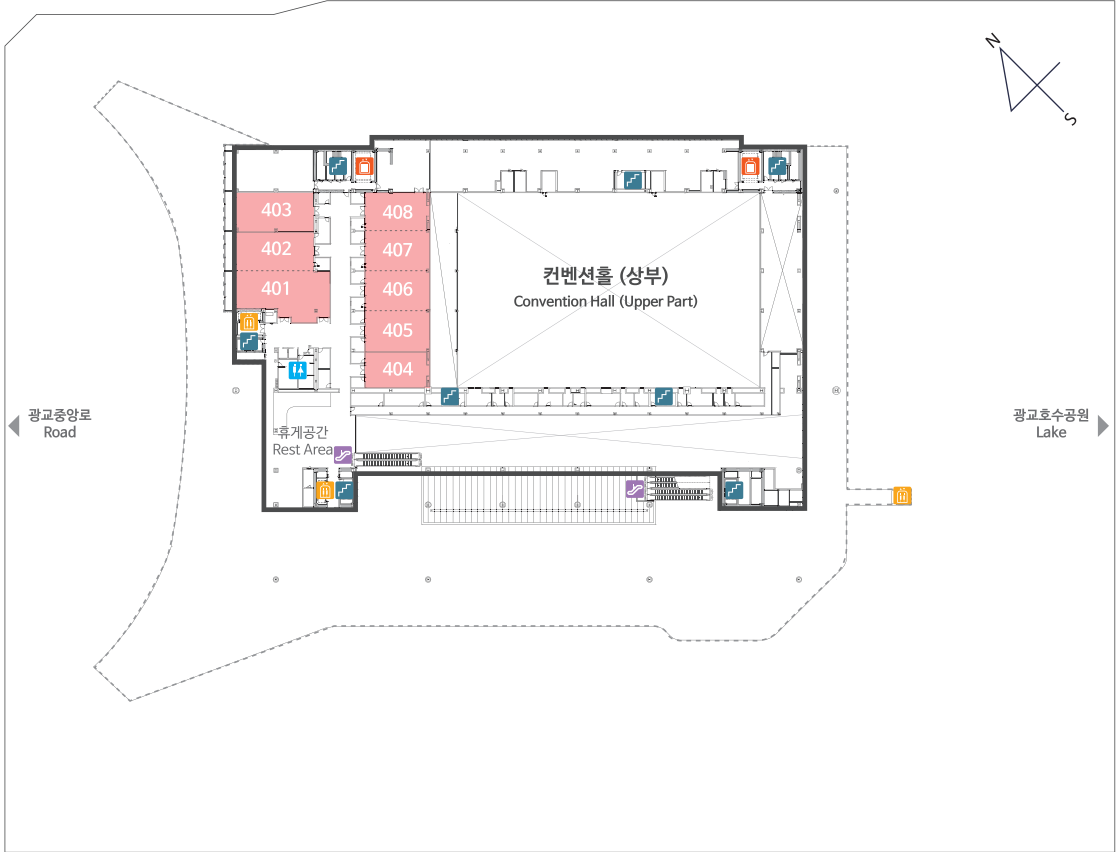

엘리베이터 | Elevator    화장실 | Restroom    계단 | Staircase    에스컬레이터 | Escalator    화물 엘리베이터 | Freight Elevator

장소 Location	규격   Size W x L x H (m)	면적   Area (㎡)	수용인원(명)   Capacity(Persons)		
			강의식   Class	극장식   Theater	연회식   Banquet
401	21.5 × 10.0 × 2.8	215	144	192	80
402	18.0 × 8.7 × 2.8	156	120	168	64
403	18.0 × 9.0 × 2.8	162	117	168	64
404	14.5 × 8.7 × 2.8	126	72	110	48
405	14.5 × 9.0 × 2.8	130	96	120	48
406	14.5 × 9.0 × 2.8	130	96	120	48
407	14.5 × 9.0 × 2.8	130	96	120	48
408	14.5 × 8.7 × 2.8	126	96	120	48
401+402	21.5 × 18.7 × 2.8	371	210	336	144
405+406	14.5 × 18.0 × 2.8	260	180	252	96
407+408	14.5 × 17.7 × 2.8	256	180	252	96
405+406+407	14.5 × 27.0 × 2.8	390	270	378	144
406+407+408	14.5 × 26.7 × 2.8	386	270	378	144
405+406+407+408	14.5 × 35.7 × 2.8	516	360	486	216



# 기타 시설

## Other Facilities



### B1 이벤트홀 Event Hall

면적 | Area 308㎡

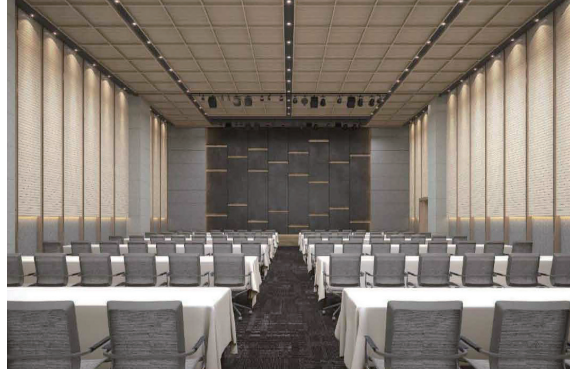
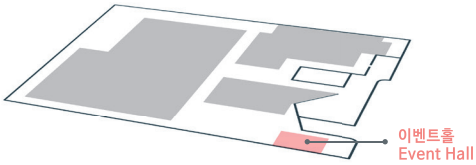

이벤트홀은 수원 시민들에게 무료로 제공되는 열린 공간입니다.

The event hall, an open space, is available for Suwon citizens for free.

전동 수납식 좌석(256석) | Motorized retractable seats

### 5F VIP 다이닝룸 VIP Dining Room

면적 | Area 217㎡

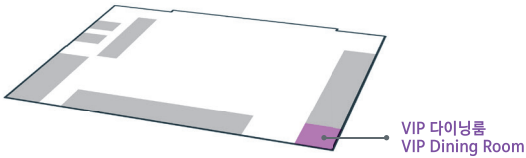

전시홀, 컨벤션홀, 회의실 대관시 호수전망의  
고품격 VIP 다이닝룸을 무료로 이용하실 수 있습니다.

※ 식사시 사용 가능

High-level VIP Dining room with a beautiful lake view is provided free of charge when leasing an exhibition hall, a convention hall or meeting rooms.

※ Catering purpose only

### RF 구름정원 Cloud Garden

면적 | Area 5,584㎡

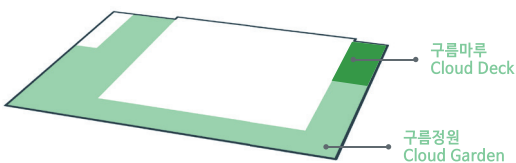

구름정원은 광고호수공원의 아름다운 풍경과 함께  
리셉션 등 특별한 행사가 가능한 공간입니다.

The Cloud Garden, boasting the beautiful view of the Gwanggyo Lake Park, is the best place for special events such as reception.

# 교통

## Transportation

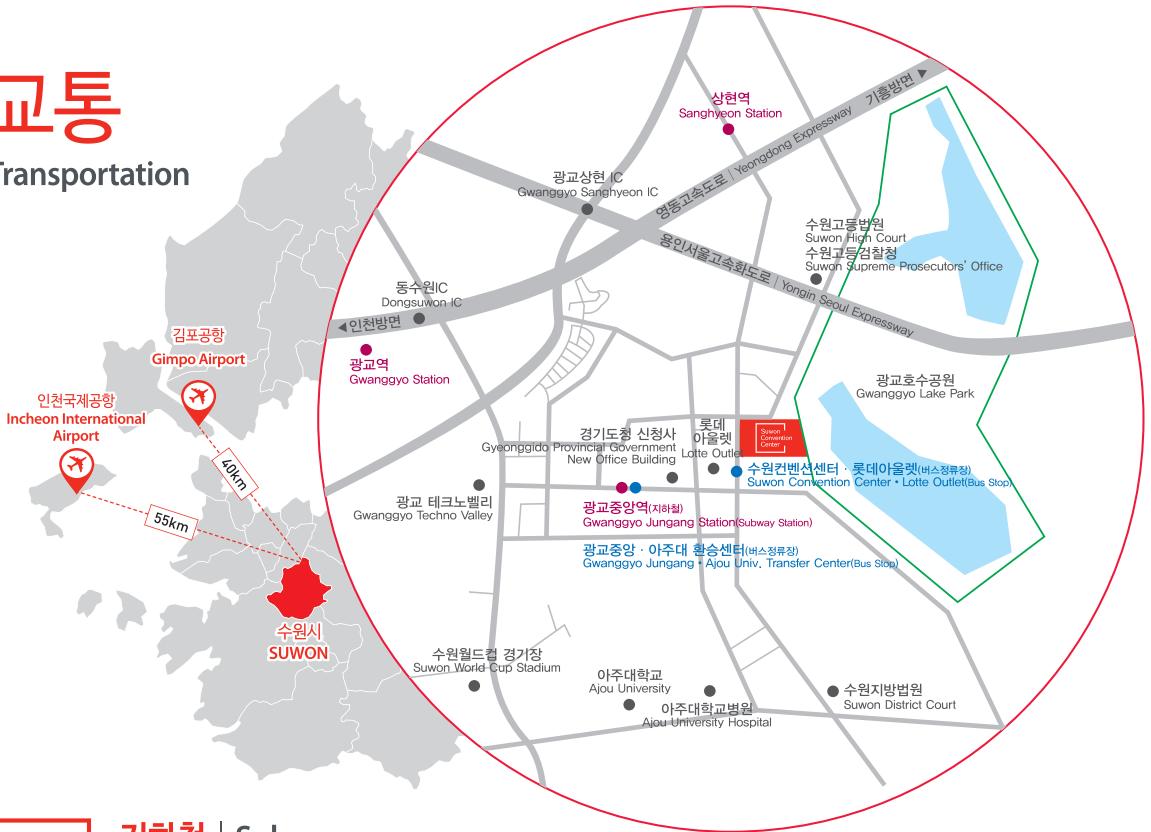

### 지하철 | Subway

신분당선 「광교중앙역」 4번 출구 → (도보 10분) → 수원컨벤션센터  
 「Gwanggyo Jungang Station」, Sinbundang Line Exit 4 → (10 min. on foot) → Suwon Convention Center



### 버스 | Bus

**광역 버스 Express Bus** 「광교중앙·아주대환승센터」 하차 → (도보 10분) → 수원컨벤션센터  
 서울역 M5115, M5121 / 강남역 M5422  
 「Gwanggyo Jungang-Ajou University Transfer Center」 → (10 min. on foot) → Suwon Convention Center  
 Seoul Station : M5115, M5121 / Gangnam Station : M5422

**시내 버스 City Bus** 「수원컨벤션센터·롯데아울렛」 하차 → (도보 3분) → 수원컨벤션센터  
 5-4, 19, 20, 32, 32-3, 32-4, 670, 720-3, 999

「Suwon Convention Center · Lotte Outlet」 → (3 min. on foot) → Suwon Convention Center  
 5-4, 19, 20, 32, 32-3, 670, 720-3, 999



### 공항리무진 | Airport Limousine

**인천공항 Incheon** 리무진버스 8877 (60~80분) → 「광교중앙·아주대환승센터」 하차 → (도보 10분) → 수원컨벤션센터  
 Limousine bus 8877(60~80 min.) → 「Gwanggyo Jungang · Ajou University Transfer Center」 → (10 min. on foot) → Suwon Convention Center

**김포공항 Gimpo** 시외버스 A4300 (80분) → 「동수원」 하차 → (택시 10분/버스 30분) → 수원컨벤션센터  
 City Bus A4300(80min.) → 「Dongsuwon Station」 → (10min. by car or 30min. by bus) → Suwon Convention Center



### 자동차 | Car

주소 : 경기도 수원시 영통구 하동 864-10  
 Address : 864-10, Ha-dong, Yeongtong-gu, Suwon-si, Gyeonggi-do, Republic of Korea

# MICE 복합단지 주요시설

## Main Facilities of MICE Multi-Complex

대한민국 최고의 광고호수공원(2014대한민국경관대상)과 MICE 복합단지의 풍부한 인프라를 기반으로 귀하의 행사에 감동적인 스토리를 더하겠습니다.

Combining the award-winning scenery of Gwanggyo Lake Park (Korea Scenery Award in 2014) and superlative infrastructures of the MICE Multi-complex, we are committed to making your events even more successful by providing participants with pleasant experiences.

### 주요시설 개요 | Facilities Information

구분 Items	호텔 Hotel	백화점 Department Store	오피스빌딩 및 아쿠아리움 Office Building and Aquarium
대지면적 Site Area	2,478㎡	12,289㎡	16,069㎡
주용도 Functions	숙박시설(288실) Accommodations (288 rooms)	판매시설 Commercial Facilities	문화 및 업무시설 Entertainment Facilities & Offices
층수 No. of Stories	지하5층 / 지상21층 5 floors below ground / 21 floors above ground	지하7층 / 지상12층 7 floors below ground / 12 floors above ground	업무동 : 지하5층 / 지상47층 아쿠아리움 : 지하 1, 2층 Office : 5 floors below ground / 47 floors above ground Aquarium : 1 floor ~ 2 floor below ground
개관예정일 Expected Opening Date	2020년 1월 January 2020	2020년 2월 February 2020	2020년 10월 October 2020

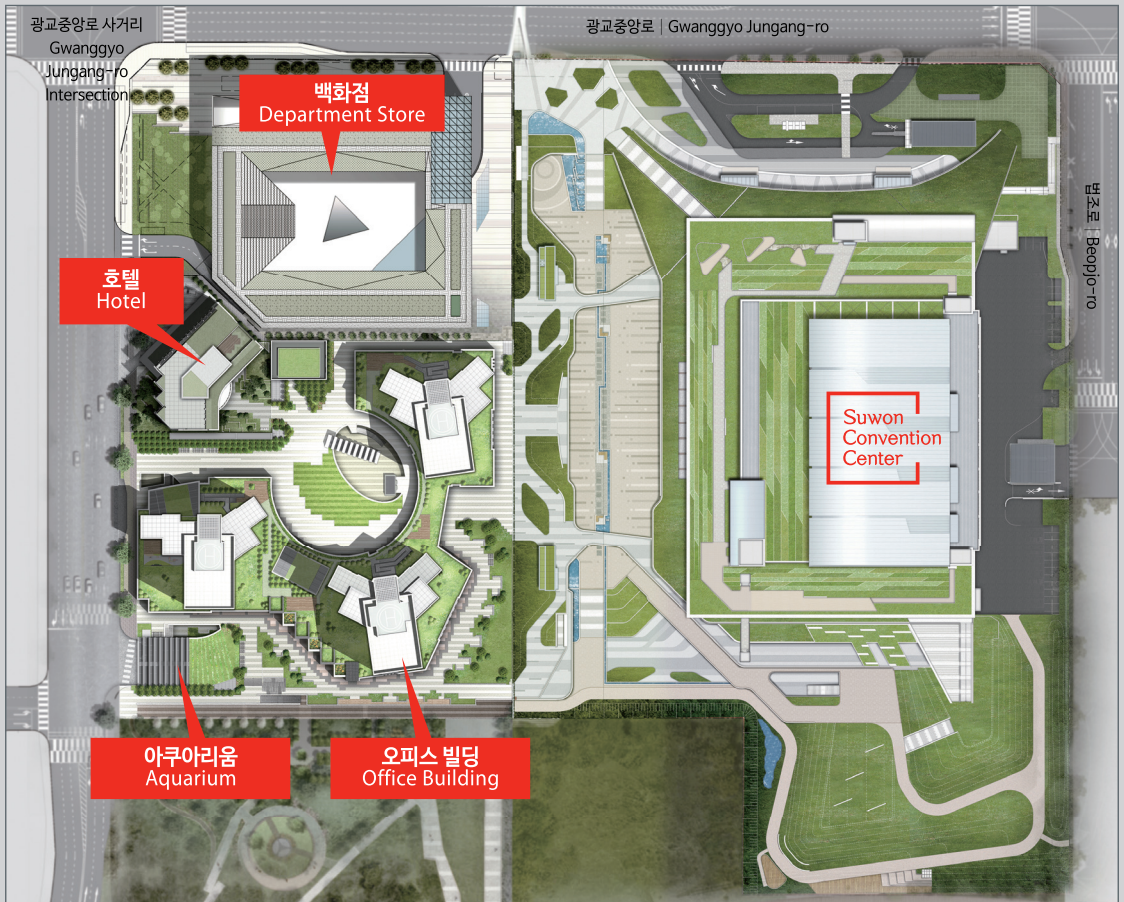

The logo for the Suwon Convention Center features the text "Suwon Convention Center" in a bold, red, sans-serif font. The text is enclosed within a red square frame that has a unique, stylized design with notched corners and a small gap at the top and bottom right.

# Suwon Convention Center

## 수원컨벤션센터

443-280 경기도 수원시 영통구 하동 864-10

864-10, Ha-dong, Yeongtong-gu, Suwon-si, Gyeonggi-do, 443-280 Republic of Korea

Website. [www.scc.or.kr](http://www.scc.or.kr) E-mail. [scc@kintex.com](mailto:scc@kintex.com)